



## 100K Ohm Stable NTC Temperature Probe 103 104 Sensor Multipurpose

Our Product Introduction

### Basic Information

- Place of Origin: Dongguan China
- Brand Name: linkun
- Certification: CE / ROHS / UL / TUV / SGS
- Model Number: NTC Temperature Sensor
- Minimum Order Quantity: Negotiation
- Price: Negotiation
- Packaging Details: Export Package / Negotiation
- Delivery Time: Negotiation
- Payment Terms: T/T, L/C, Western Union
- Supply Ability: 24 million per year



### Product Specification

- Features: Fast Response
- Application: Electronic Product
- Type: Thermistor
- Working Temperature Range(°C): -10 To +105c
- Resistance Value: 5K, 10K, 20K, 50K, 100K
- Dissipation Factor(mw/°C): 1-2 (in Still Air)
- Highlight: **100K Ohm NTC Temperature Probe, Stable NTC Temperature Probe, Multipurpose NTC Temp Probe**

for more products please visit us on [lk-thermistor.com](http://lk-thermistor.com)

## Product Description

### Temperature Controller Sensor NTC Thermistor Probe Ohm 100K Ttc 103 104 NTC Sensor

We have the unique process and leader core technology with proprietary intellectual property rights of ceramic powder equipment, made of chips, high performance NTC Automatic batch production.

We have more than 12 series of high performance NTC thermistors automatic production line, products have the advantages of large production, high quality, good coherence, high reliability, besides it can be made of many kinds of NTC temperature sensors, it also can be supplied to other factories of NTC sensors, and exported in large quantities to overseas.

#### Advantages

We have the heart of NTC temperature sensor--full sets of production line and core technology of pro-prietary intellectual property rights for high performance temperature measurement NTC thermistor.

We have all kinds of NTC core element of NTC Temperature sensor--high performance temperature measurement thermistors are own production, complete series, structural diversity. Our products can meet the requirements of precision measurement in different temperature area from low temperature, medium and low temperature to medium-high temperature. These products have passed many safety certifications of domestic and foreign.

Resistance and temperature characteristics can meet customer's requirements entirely, and support best convenience to customers.

Mature manufacturing technique of NTC temperature sensor, Large-scale mass production, product have the best ability of insulation sealing, Mechanical collision, resistance to bending, well-set.

Small thermal time, fast response

Multi category, complete series, many kinds of housing he configuration, easy to assemble

We have high level inspection equipments which carry out strict and normative inspection process.

|                   |  |
|-------------------|--|
| Type              | NTC(thermistor) Temperature Sensor   |
| Temperature range | -50°C ~ +300°C Customized  |
| Accuracy          | 1% 5% 10%  |
| RT(25°C)          | 1K 2K 2.2k 2.7k 3K 5K 7K 8K 12K 15K 20K 25K 30K 40K 47K 50K 60K 70K 100K 200K 230K 250K 470K 500K 1000K Customized |
| B value           | 3274 3435 3470 3928 3950 3977 4100 4200 4400 Customized  |
| Probe Material    | Stainless steel SS304 aluminum copper plastic epoxy glass  |
| Installation      | Flanged Surface Threaded Plastic Straight Film Customized  |
| Wire Material     | Heat shrinkable tube PVC tube glass fiber tube tube  |
| Connector         | Molex JST DuPont CWB CJT U type Customized   |
| Waterproof        | IP67 IP68  |

#### NTC thermistor temperature sensor characteristics:

1. High precision and high stability
2. Fast response
3. Excellent thermal shock resistance
4. Excellent moisture resistance
5. High-tech batch production ensures high quality and high stability of products.

#### Application

- Air conditioners, refrigerators, freezers, water heaters, water dispensers, heaters, dishwashers, disinfection cabinets, washing machines, dryers and other home appliances.
- Automobile air conditioner, water temperature sensor, intake air temperature sensor, engine
- Switching power supply, UPS uninterruptible power supply, frequency converter, electric boiler, etc.
- Intelligent toilet, electric blanket, etc.



Flanged ntc temp sensor



Surface ntc temp sensor



Threaded ntc temp sensor

#### Working principle of temperature sensor

Using the NTC thermistor under a certain measurement power, the resistance value drops rapidly as the temperature rises. Utilizing this feature, the NTC thermistor can be used to determine the corresponding temperature by measuring its resistance value, so as to achieve the purpose of detecting and controlling the temperature.

## Flanged Probes

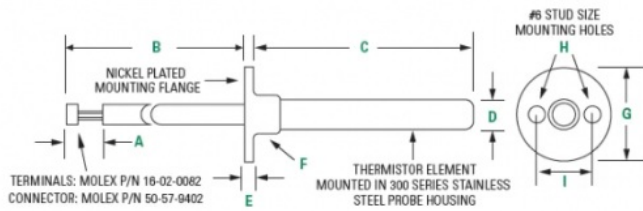

## Threaded Probes

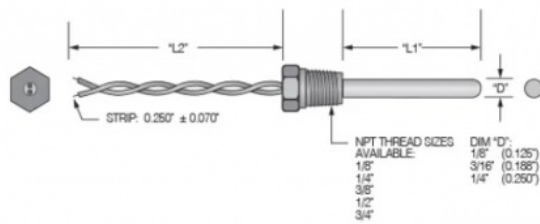

## Special Probes: Customized according to purpose

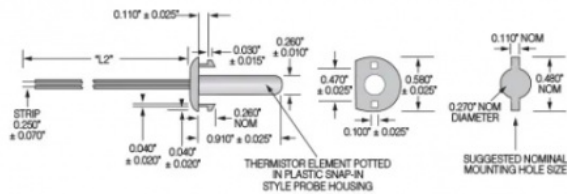

## Surface Probes

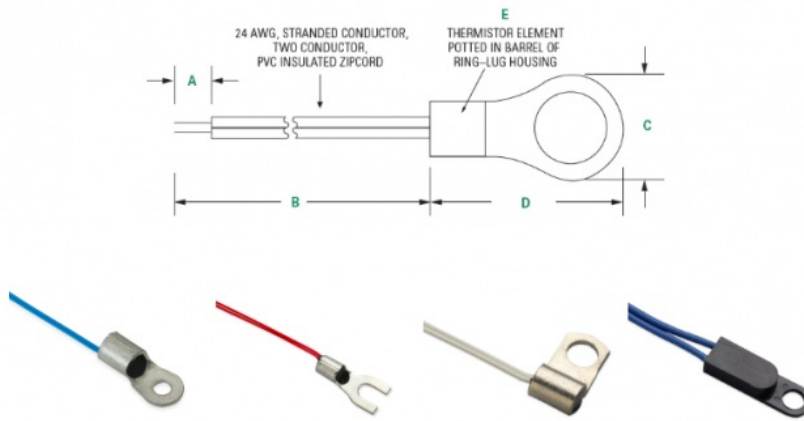

### Conventional product electrical performance parameters

| Part No.    | R25°C<br>(K $\Omega$ ) | B(K)<br>25/50°C | Rated Power<br>@25°C(mW) | Dissipation Factor( $\delta$ )<br>(mW/°C) | Thermal time<br>Constant (S) |
|-------------|------------------------|-----------------|--------------------------|---|------------------------------|
| TS502□3274A | 5.0                    | 3274            | 10-20                    | 2-4                                       | 5-20                         |
| TS502□3435B | 5.0                    | 3435            | 10-20                    | 2-4                                       | 5-20                         |
| TS502□3470A | 5.0                    | 3470            | 10-20                    | 2-4                                       | 5-20                         |
| TS502□3950A | 5.0                    | 3950            | 10-20                    | 2-4                                       | 5-20                         |
| TS103□3274A | 10.0                   | 3274            | 10-20                    | 2-4                                       | 5-20                         |
| TS103□3435B | 10.0                   | 3435            | 10-20                    | 2-4                                       | 5-20                         |
| TS103□3470A | 10.0                   | 3470            | 10-20                    | 2-4                                       | 5-20                         |
| TS103□3950A | 10.0                   | 3950            | 10-20                    | 2-4                                       | 5-20                         |
| TS103□4100A | 10.0                   | 4100            | 10-20                    | 2-4                                       | 5-20                         |
| TS153□3950A | 15.0                   | 3950            | 10-20                    | 2-4                                       | 5-20                         |
| TS153□4100A | 15.0                   | 4100            | 10-20                    | 2-4                                       | 5-20                         |
| TS203□3950A | 20.0                   | 3950            | 10-20                    | 2-4                                       | 5-20                         |
| TS203□4100A | 20.0                   | 4100            | 10-20                    | 2-4                                       | 5-20                         |
| TS223□4200A | 22.0                   | 4200            | 10-20                    | 2-4                                       | 5-20                         |
| TS403□3928A | 40.0                   | 3928            | 10-20                    | 2-4                                       | 5-20                         |
| TS503□3950A | 50.0                   | 3950            | 10-20                    | 2-4                                       | 5-20                         |
| TS503□4100A | 50.0                   | 4100            | 10-20                    | 2-4                                       | 5-20                         |
| TS104□3950A | 100.0                  | 3950            | 10-20                    | 2-4                                       | 5-20                         |
| TS104□4100A | 100.0                  | 4100            | 10-20                    | 2-4                                       | 5-20                         |
| TS104□4400A | 100.0                  | 4400            | 10-20                    | 2-4                                       | 5-20                         |

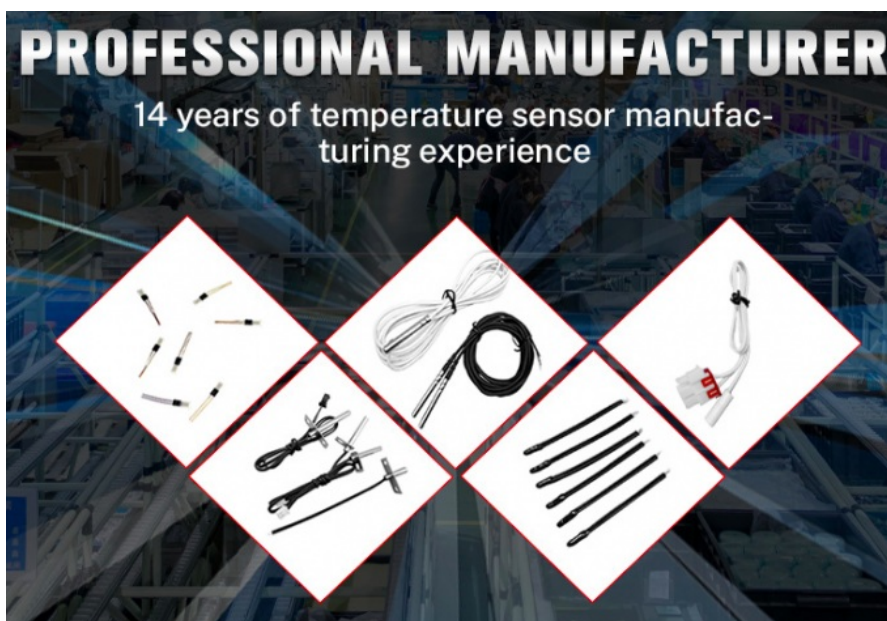

### Application



**Dongguan Linkun Electronic Technology Co., Ltd.**



13423305709



huangju@lk-ptc.com



lk-thermistor.com

Room 101, No. 21, Huayuanzai Road, Chongmei, Chashan Town, Dongguan City, Guangdong Province